

European Profile Mortise Lock

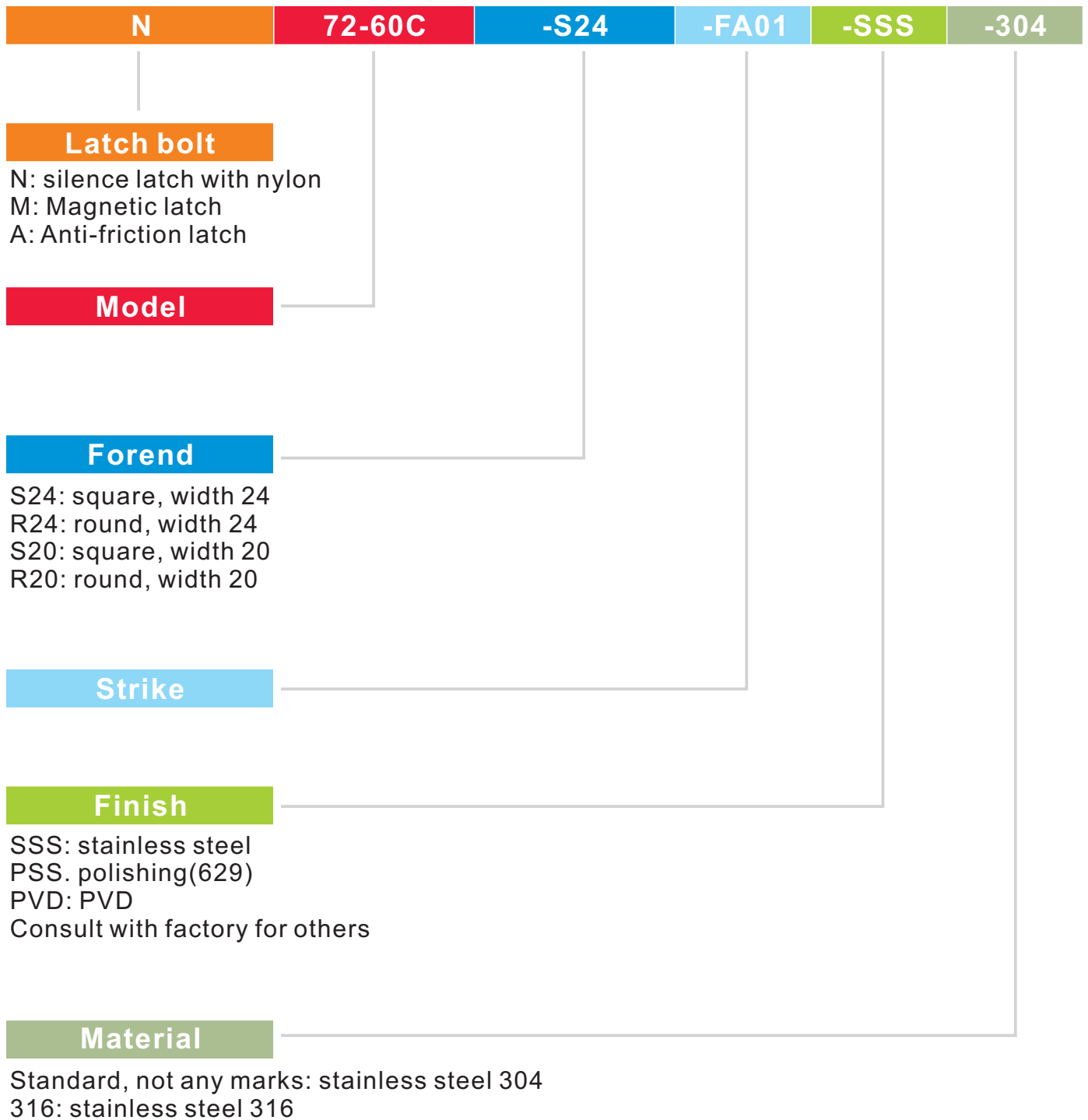

72-55A/72-60A/72-65A

Sash lock

1. Lock case seal, zinc plated
2. Latch and bolt is stainless steel 304
3. Bolt projection, double throw, 20mm
4. 8mm square steel follower in steel
5. Hole for standard fixings
6. Non handed
7. CE certificate, 4 hours fire rate
8. EN12209: 3X91^b0G2BC10

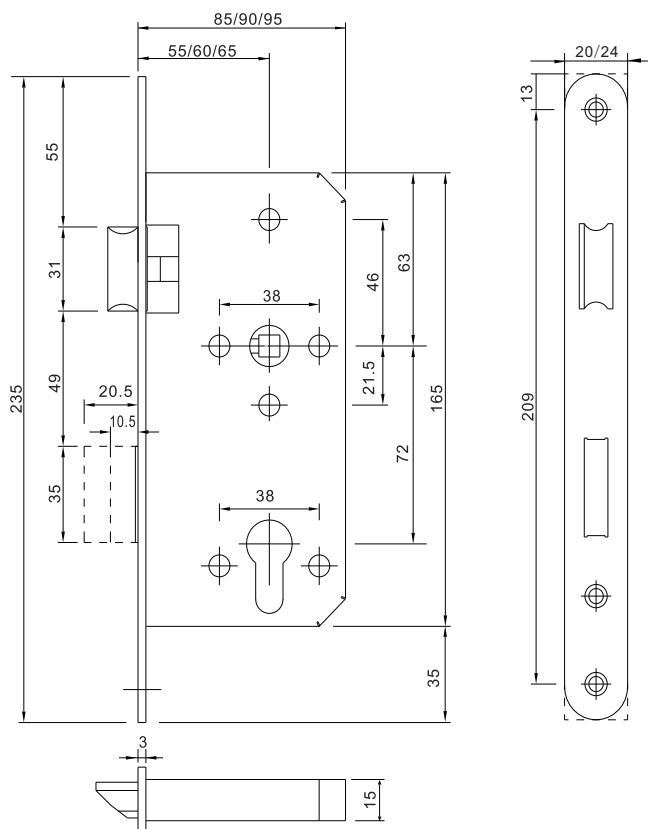

78-55WC/78-60WC/78-65WC

Bathroom lock

1. Follower to keyway centers 78mm
2. Lock case seal, zinc plated
3. Latch and bolt is stainless steel 304
4. Bolt projection, double throw, 20mm
5. 8mm square steel follower in steel
6. Hole for standard fixings
7. Non handed
8. CE certificated, fire rated 4 hours
9. EN12209: 3X91^b0G0BG10

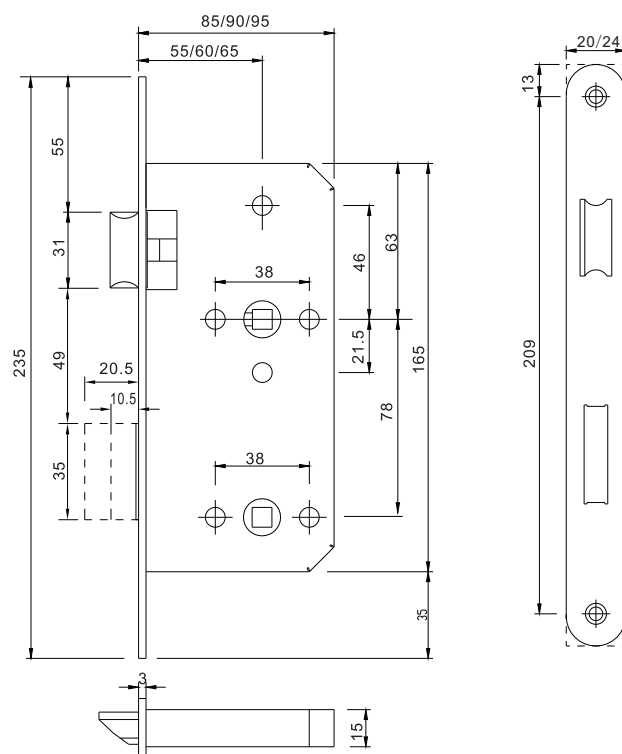

72-55L/72-60L/72-65L
Latch bolt Fire rated lock

1. Lock case seal, zinc plated
2. Latch is stainless steel 304
3. 8mm square steel follower in steel
4. Hole for standard fixings
5. Non handed
6. CE certificated, fire rated 4 hours
7. EN12209: 3X91^b0G0B010

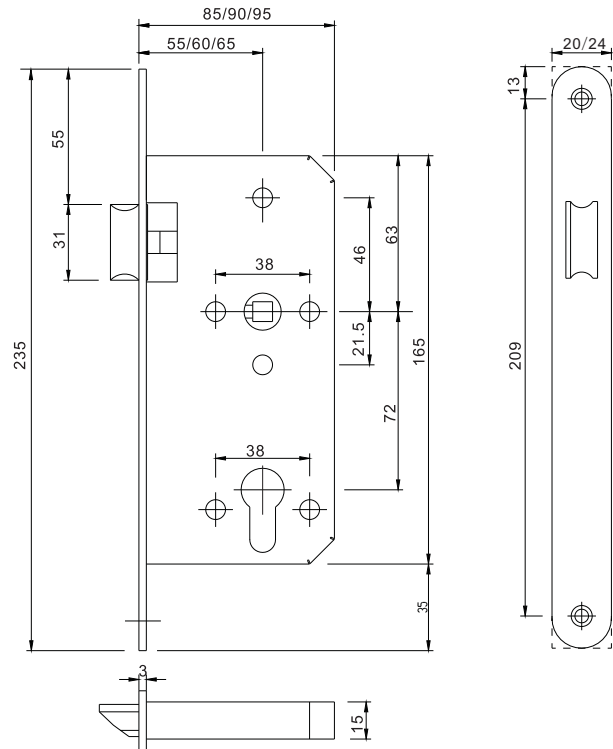

72-55D/72-60D/72-65D
Dead bolt lock

1. Lock case seal, zinc plated
2. Deadbolt is stainless steel 304
3. Bolt projection, double throw, 20mm
4. 8mm square steel follower in steel
5. Hole for standard fixings
6. Non handed
7. CE certificated, fire rated 4 hours
8. 3C-1^b0G2BA10

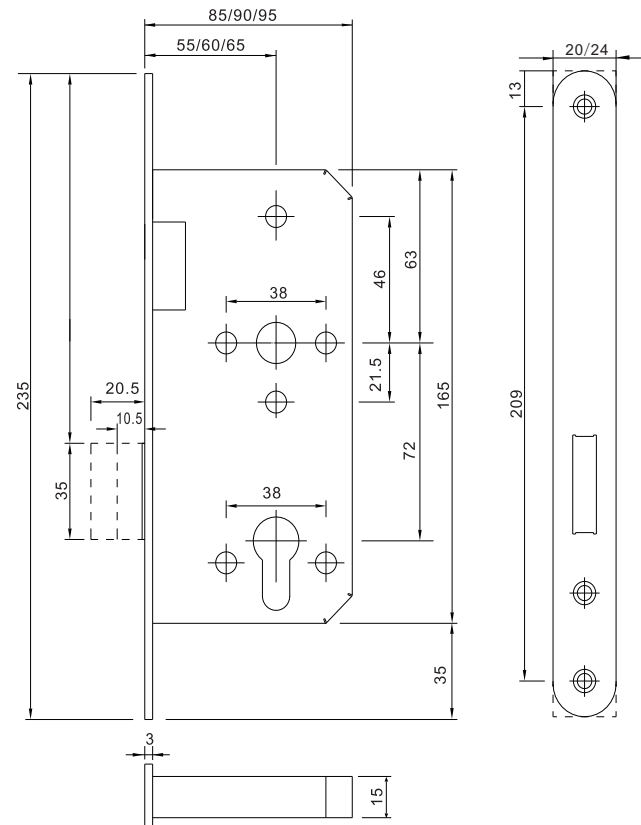

72-60F

Night latch lock

1. Lock case seal, zinc plated
2. Latch is stainless steel 304
3. 8mm square steel follower in steel
4. Hole for standard fixings
5. Non handed
6. CE certificated, fire rated 4 hours
7. EN12209: 3X91°0G2BA10

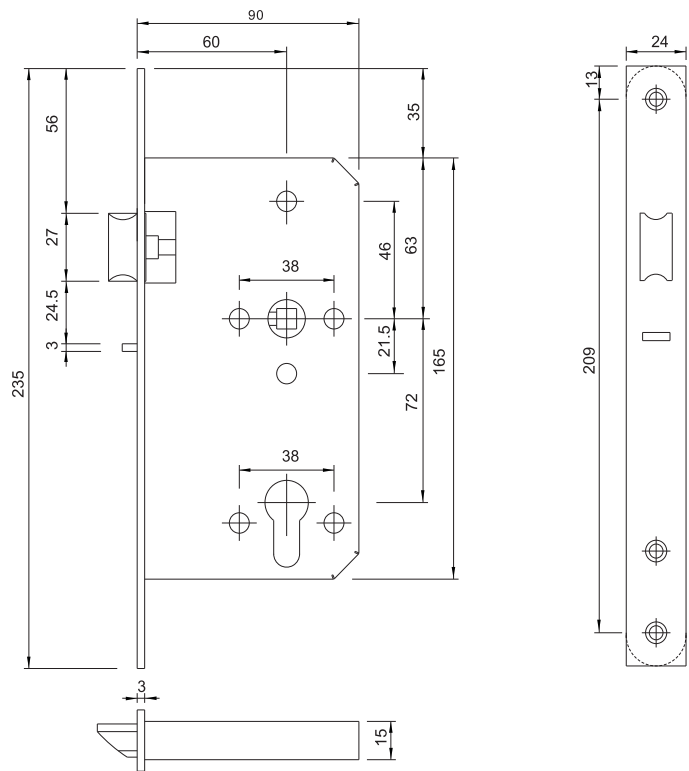

72-60C/72-65C

Classroom lock

1. Lock case seal, zinc plated
2. Latch is stainless steel 304
3. 8mm square steel follower in steel
4. Hole for standard fixings
5. Non handed
6. CE certificated, fire rated 4 hours
7. 3X91°0G2BA10

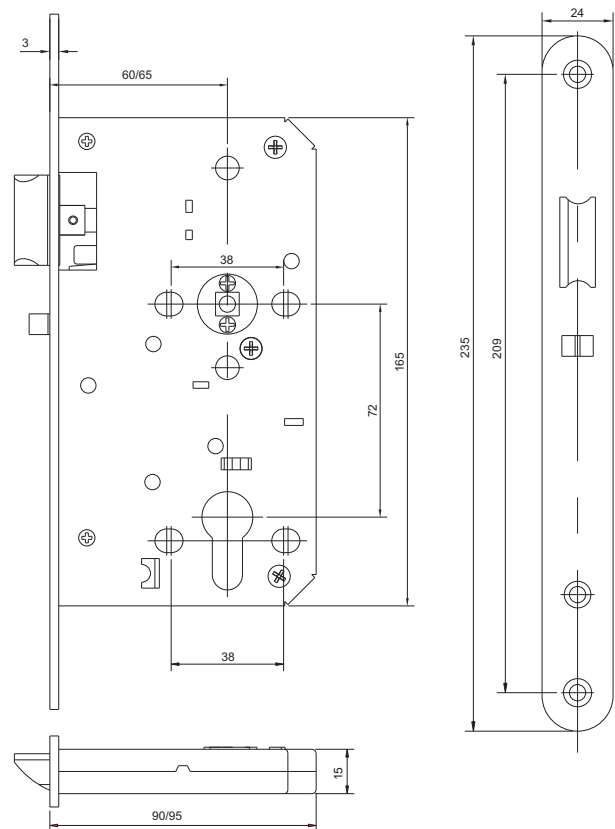

72-60T/72-65T

Exit lock

1. Lock case seal, zinc plated
2. Latch and bolt is stainless steel 304
3. Bolt projection, double throw, 20mm
4. 8mm square steel follower in steel
5. Hole for standard fixings
6. Non handed
7. CE certificate, fire rated 4 hours
8. EN12209: 3X91^b0G2BA10
9. EN179: 376B^b1322AB

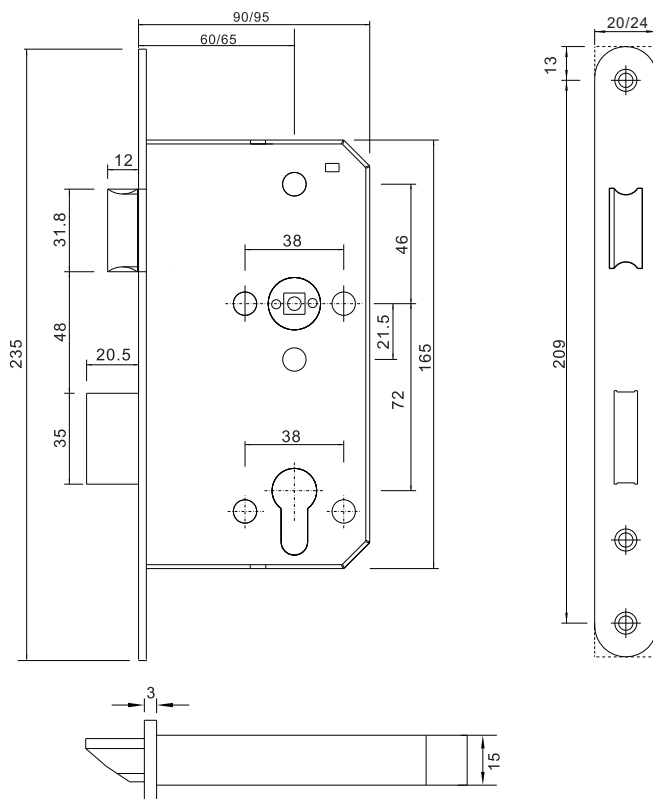

72-60TA

Exit lock with anti-thrust

1. Lock case seal, zinc plated
2. Latch and bolt is stainless steel 304 with auxiliary latch
3. Bolt projection, double throw, 20mm
4. 8mm square steel follower in steel
5. Hole for standard fixings
6. Non handed
7. Compliance to EN12209
8. Compliance to EN179

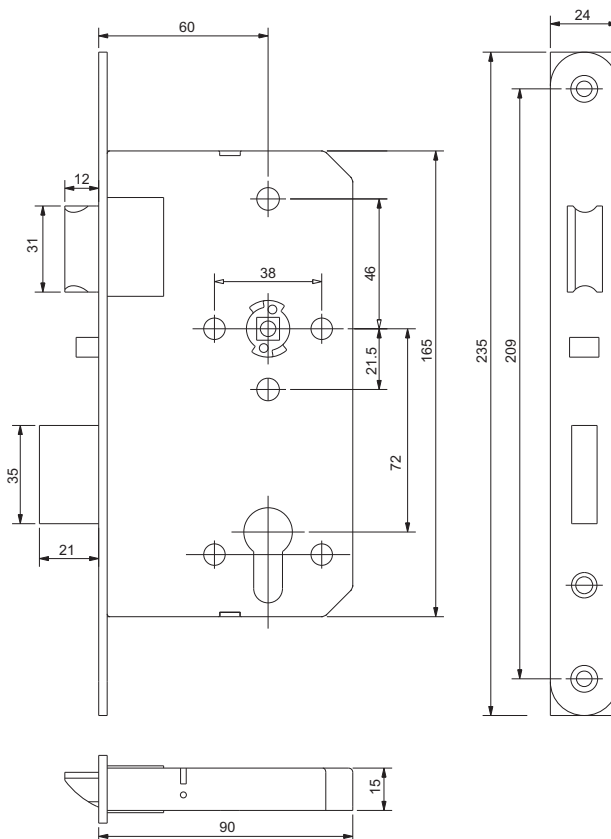

72-55/60/65TF

Automatic Deadbolt Locking Mortise Lock

1. Lock case seal, zinc plated
2. Latch and bolt is stainless steel 304
3. Bolt projection, one throw, 20mm
4. 8mm square steel follower in steel
5. Non handed
6. EN12209 in preparation

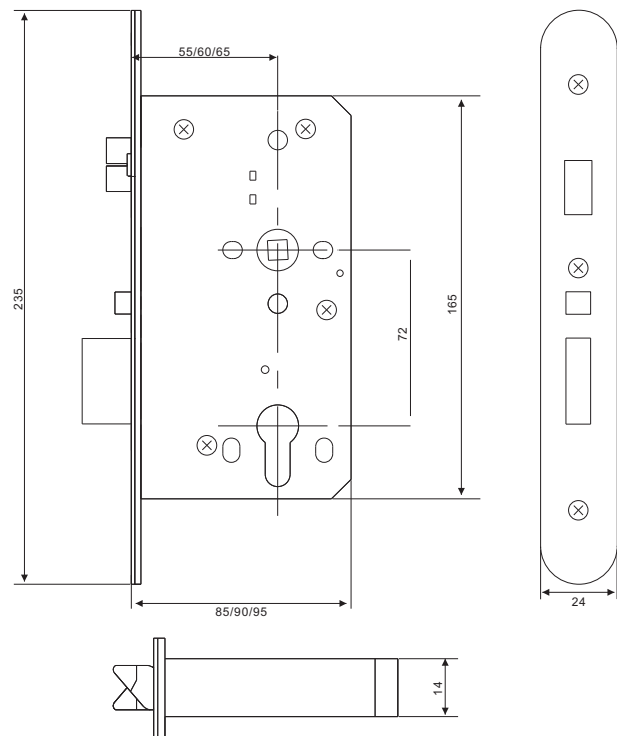

72-55/60/65P

Roller latch

1. Lock case seal, zinc plated
2. Roller latch is stainless steel 304
3. Hole for standard fixings
4. Non handed

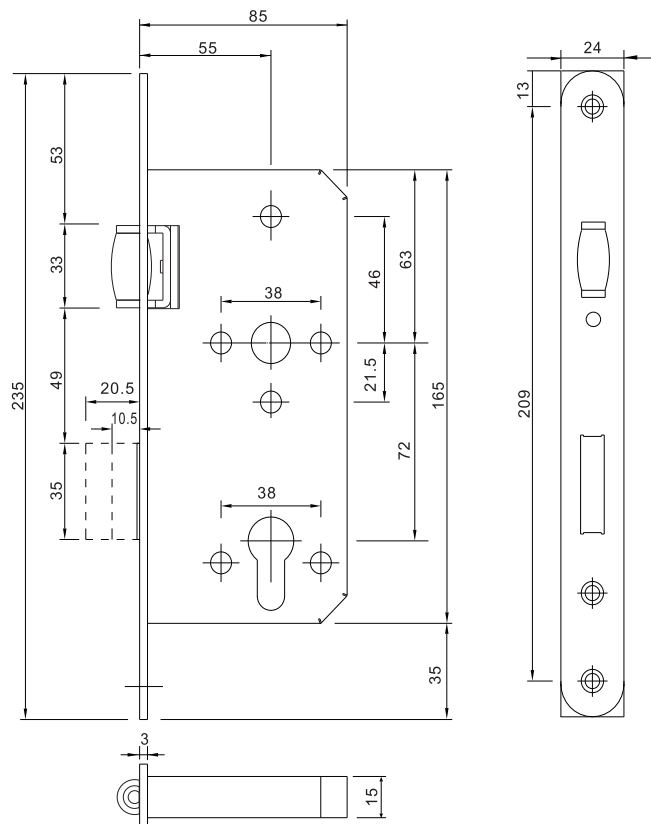

80-55/60A

Sash lock

1. Lock case seal, zinc plated
2. Latch and bolt is stainless steel 304
3. Bolt projection, double throw, 20mm
4. 8mm square steel follower in steel
5. Hole for standard fixings
6. Non handed

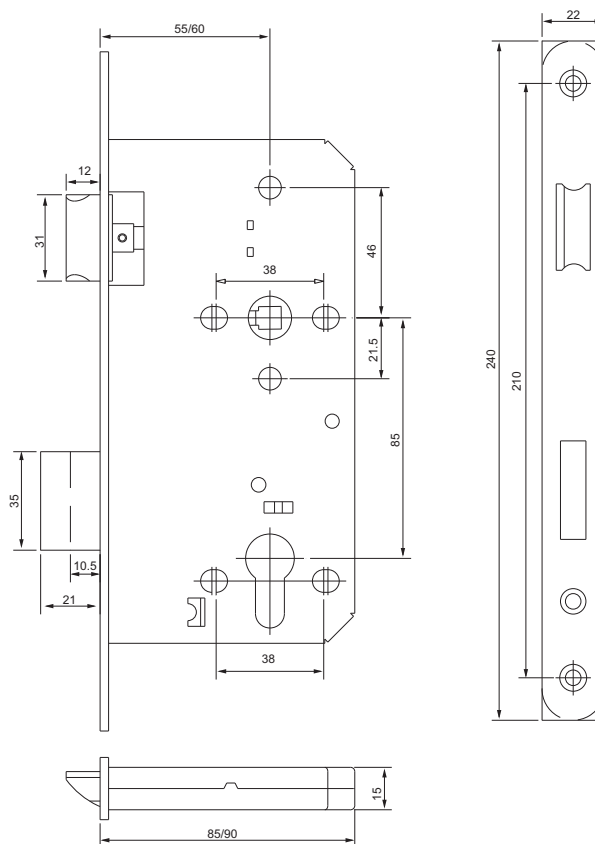
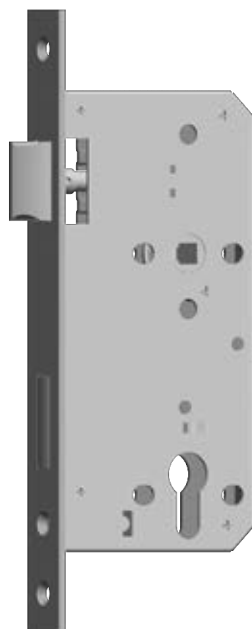

N72-xxA/L /C/F/T/TA

Lock with silence latch

Latchbolt with plastic piece to decrease noise
These latchbolt can apply to all locks which with latch bolt
"N" means silence latch bolt Lock with silence latch

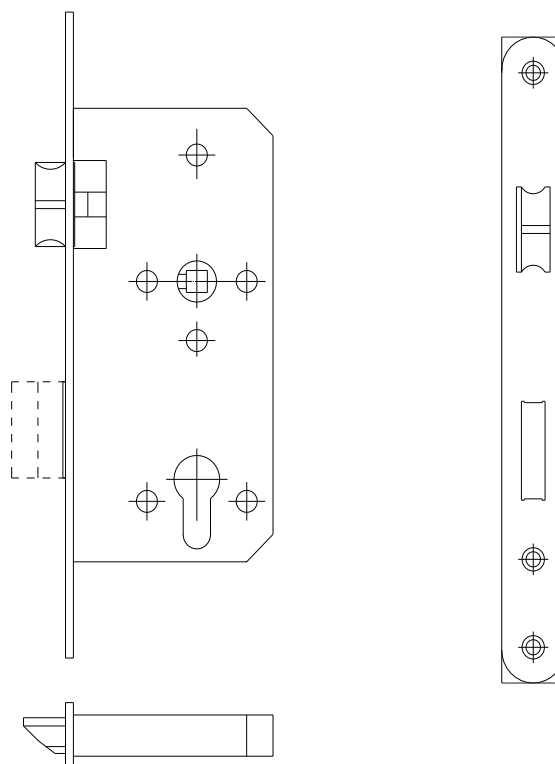

A72-xxA/L/C/F/T/TA

Anti-Friction

All latch can be change into anti-friction

"A" means anti-friction latch

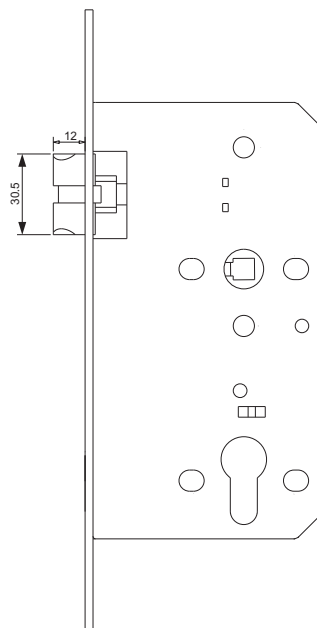
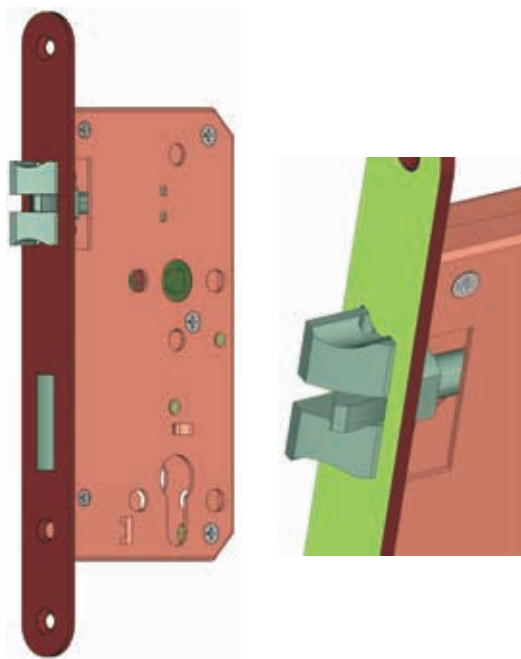

M72-xxA/L /C/T/TA

Lock with magnetic latch

Latchbolt is magnet

These latchbolt can apply to all locks which with latch bolt

"M" means Lock with magnetic latch

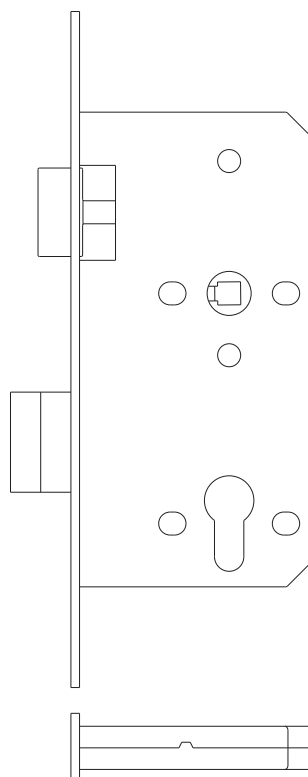

30-85A/92A, 35-85A/92A

Narrow lock

1. Lock case seal, zinc plated
2. Latch and bolt is stainless steel 304
3. Bolt projection, double throw, 16mm
4. 8mm square steel follower in steel
5. Hole for standard fixings
6. Non handed
7. EN12209 in preparation

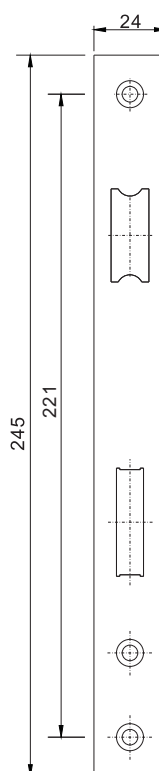
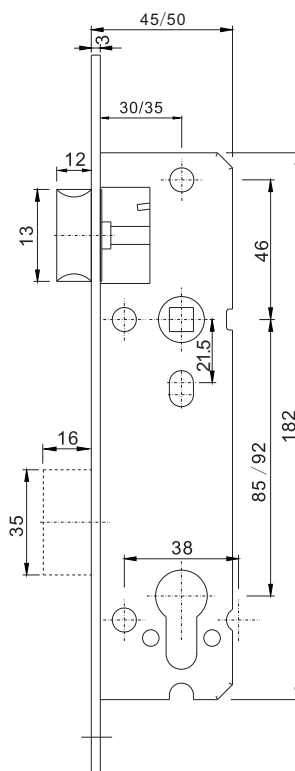

30-85L/92L, 35-85L/92L

Narrow latch lock

1. Lock case seal, zinc plated
2. Latch is stainless steel 304
3. 8mm square steel follower in steel
4. Hole for standard fixings
5. Non handed
6. EN12209 in preparation

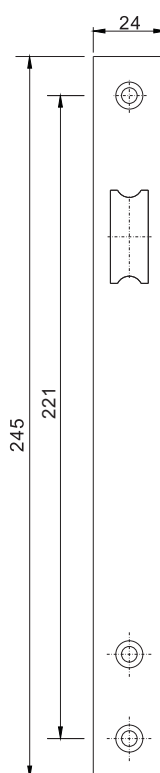
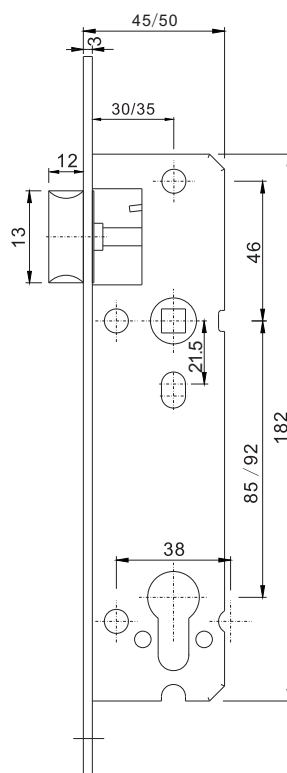

30-85D/92D, 35-85D/92D Narrow dead lock

1. Lock case seal, zinc plated
2. Bolt is stainless steel 304
3. Bolt projection, double throw, 16mm
4. Hole for standard fixings
5. Non handed
6. EN12209 in preparation

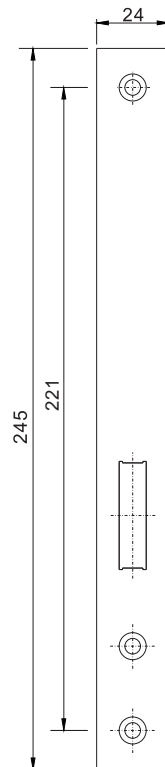
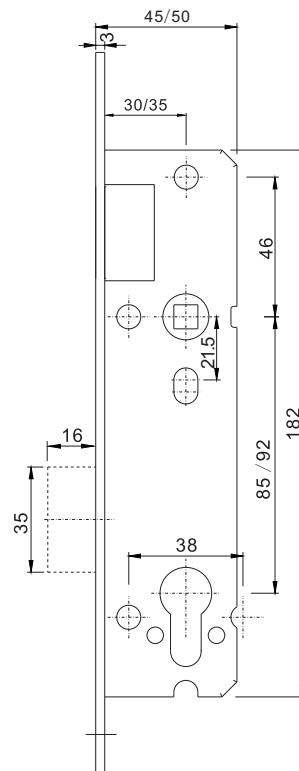

30-85P/92, 35-85/92P Roller lock

1. Lock case seal, zinc plated
2. Roller latch is stainless steel 304
3. Hole for standard fixings
4. Non handed
5. EN12209 in preparation

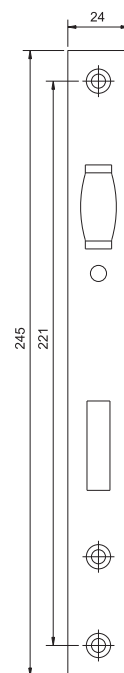
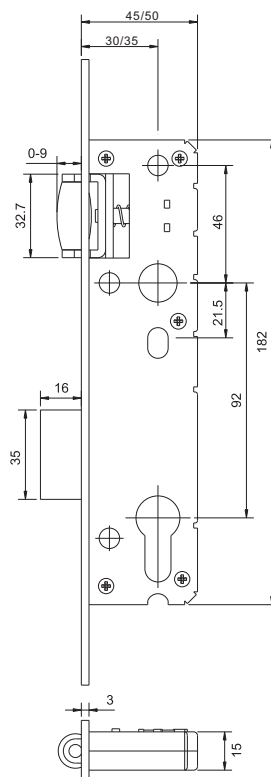

55-D/60-D Dead Bolt Fire Rated Lock

1. Dead bolt is made by stainless steel 304
2. Forend is made by stainless steel 304
3. Follower is casting stainless steel 304
4. Non Handed

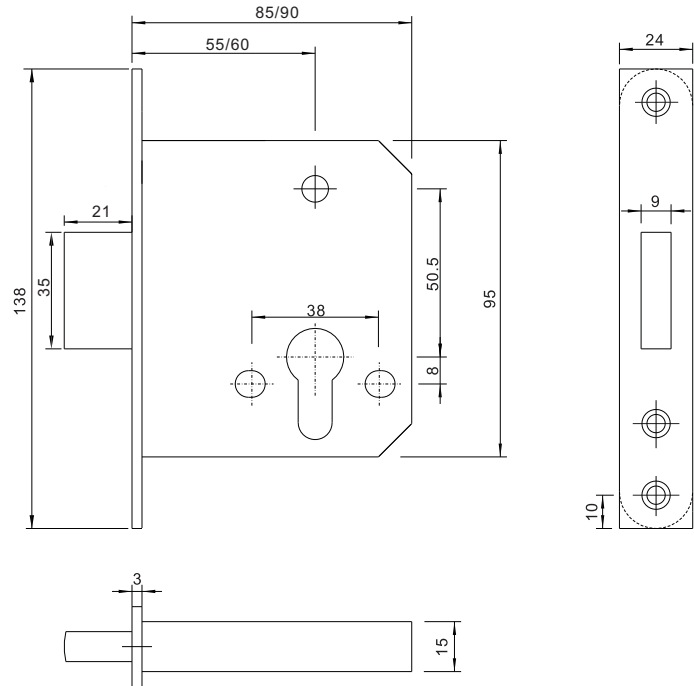

55-L Latch Bolt Fire Rated Lock

1. Latch is made by stainless steel 304
2. Forend is made by stainless steel 304
3. Follower is casting stainless steel 304
4. Non Handed

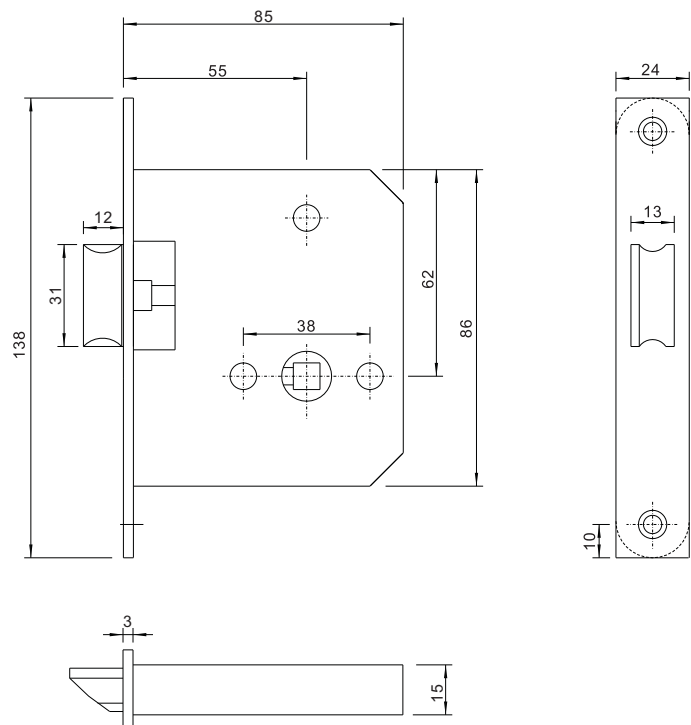

55-P

Roller latch

1. Roller is made by stainless steel 304
2. Forend is made by stainless steel 304
3. Non Handed

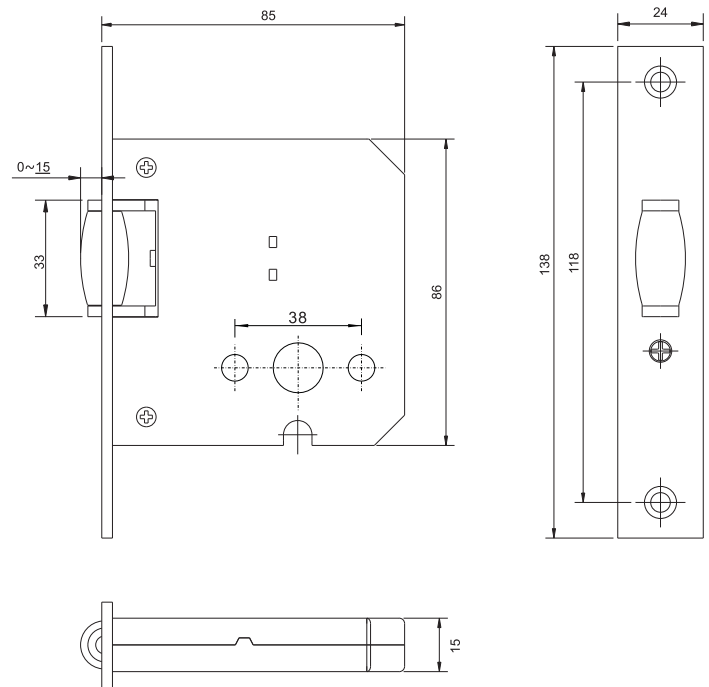

Strike

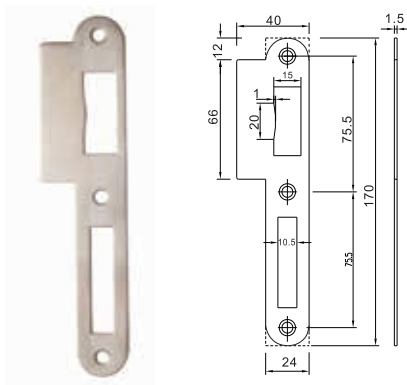

FA01S: square
RA01R: round
For A, WC, T, TA lock

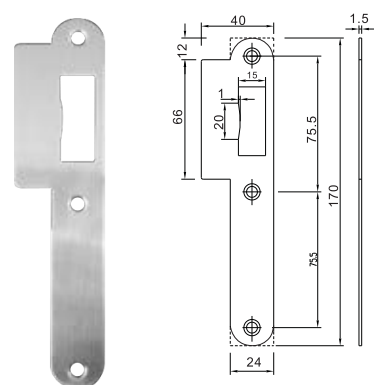

FA01LS: square
FA01LR: round
For L loc

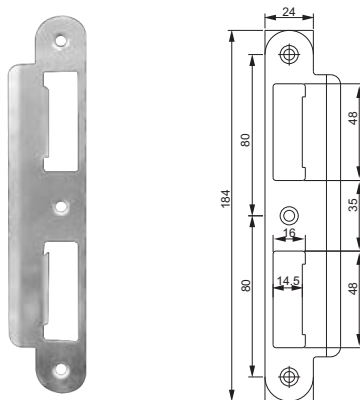

FA02LS: square
FA02LR: round
For A, WC, T, TA lock

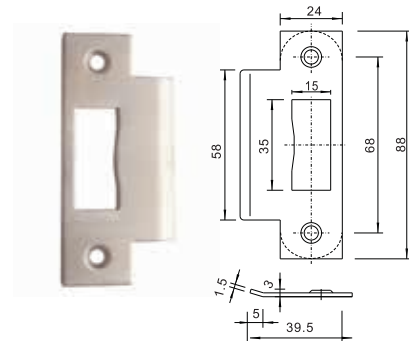

FA03S: square
FA03R: round
For L, 55L lock

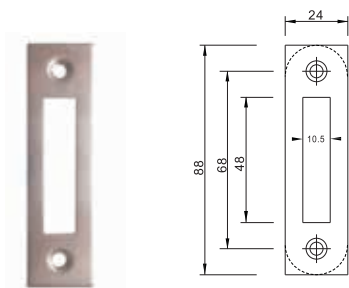

FA04S: square
FA04R: round
For D, 55D lock

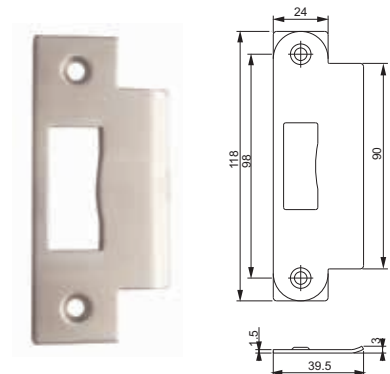

FA05S: square
FA05R: round
For C, F lock



Certificate:
1. EN1303: 160B0C6D
2. EN1634, fire rated

Key/Turn Cylinder

FDS-xx-Dxx: certificate
Without FDS: no certificate



Dimension(mm)

A	B	C
65	32.5	32.5
70	35	35
75	37.5	37.5
80	40	40

Half Cylinder

FDS-xx-DS: certificate
Without FDS: no certificate



Dimension(mm)

A	B	C
40	35	10
45	40	10

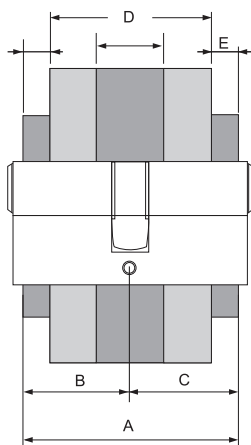

$$A = D + E \times 2$$

D-Thickness of door
E-Height of escutcheon

E usually this is one escutcheon on each side of the door

Always check the mortise lock is fitted in the middle of the door if not, an offset cylinder is requirement.

Key/Key Cylinder

FDS-xx-SK: certificate
Without FDS: no certificate



Dimension(mm)

A	B	C
65	32.5	32.5
70	35	35
75	37.5	37.5
80	40	40

Turn Models



D01



D02



D03

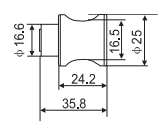
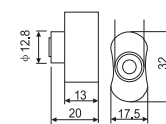
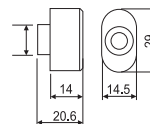

Master Key Over Key and Construction Key

6 Levers is available

